

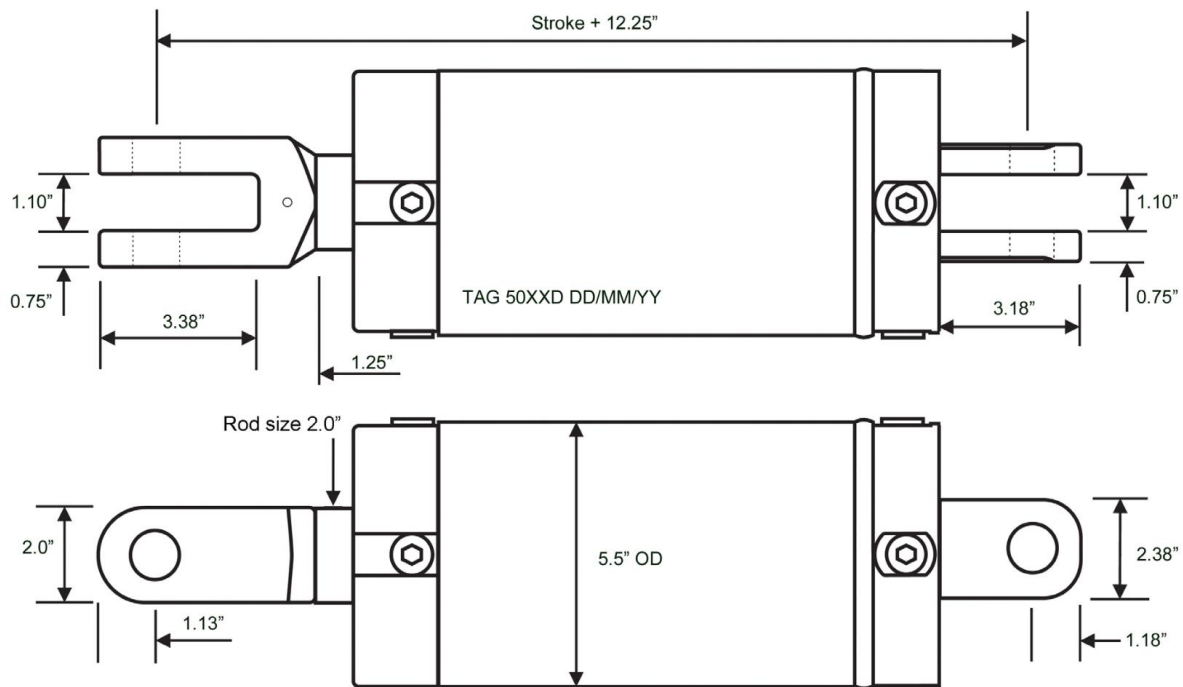

HYDRAULIC CYLINDERS AG CYLINDERS – 5" BORE

Part Number	Stroke	Closed	Open	Description
TAG 5008D	8"	20.25"	28.25"	Maximum Pressure: 3500psi (240bar) Ports: 3/4" UNO Pins: 1" pins
TAG 5012D	12"	24.25"	36.25"	
TAG 5016D	16"	28.25"	44.25"	
TAG 5018D	18"	30.25"	48.25"	
TAG 5020D	20"	32.25"	52.25"	
TAG 5024D	24"	36.25"	60.25"	
TAG 5030D	30"	42.25"	72.25"	
TAG 5036D	36"	48.25"	84.25"	
TAG 5048D	48"	60.25"	108.25"	



	Theoretical Cylinder Thrust - 5" Bore									
Pressure (Bar)	20	40	60	80	100	120	140	160	180	200
Extension Force (N)	25340	4560	6840	9120	11400	13680	15960	18240	20520	22800
Retraction Force (N)	21280	3010	4510	6020	7520	9030	10530	12030	13540	15040